



## Case Study

### National Diving & Activity Centre, Tidenham, Gloucestershire

#### Background

When the existing access arrangements for the National Diving & Activity Centre was found to be unsafe, Cole Easdon Consultants (CEC) were asked to design a new Major/Minor Priority Junction on the A48 Trunk Road.

The new junction was required as part of a Section 278 Agreement, where the new access arrangement replaced the existing junction, and provided access to the Diving & Activity Centre which is located within a redundant quarry workings.

#### Client

National Diving & Activity Centre Ltd.

#### CEC Input

- Detailed design to obtain Section 278 technical approval
- Liaison with utility companies with regard to plant diversions
- Provision of construction drawings and specifications
- Stage 2 and 3 Road Safety Audits and Designer's Response documents

#### Benefits of Our Involvement

- Our long standing professional relationships with technical officers from many highway authorities, enabled CEC to resolve complex technical problems quickly, and obtain the necessary technical approvals in good time.
- Early meetings with the utility companies to discuss impacts upon the buried plant provided the opportunity to adjust the design, to minimise impacts upon plant and therefore reduce costs attributable to the client.

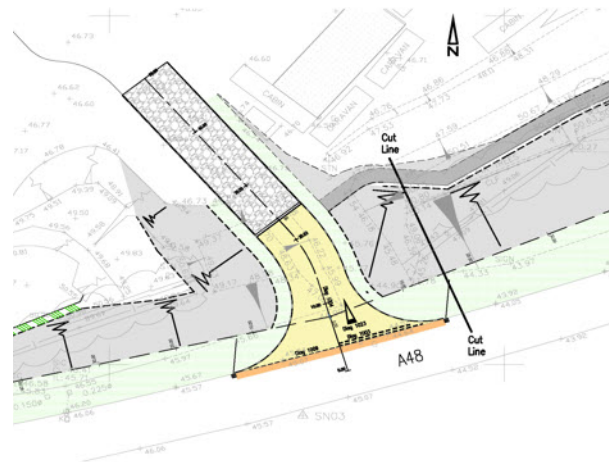

**Bristol Office**  
160 Aztec, Aztec West  
Almondsbury  
Bristol  
BS32 4TU  
Tel: 01454 800 474  
Email: [br@ColeEasdon.com](mailto:br@ColeEasdon.com)

#### COLE EASDON CONSULTANTS

CIVIL ENGINEERING ~ HIGHWAYS  
TRANSPORTATION ~ FLOOD RISK  
BRISTOL & SWINDON

**Swindon Office (Head Office)**  
Unit 2, York House  
Edison Park, Dorcan Way  
Swindon, Wiltshire  
SN3 3RB  
Tel: 01793 619 965  
Email: [sn@ColeEasdon.com](mailto:sn@ColeEasdon.com)